

THERMAL RESISTANCE DATA. (SINK TO AMBIENT)

CONDITIONS: AIR NATURAL
 MATERIAL: PBX EXTRUSION TO DWG. 39-1512
 (LENGTHS AS INDICATED)
 WEIGHT: 29.0 Kg/m
 C.S.A: 11007 mm²

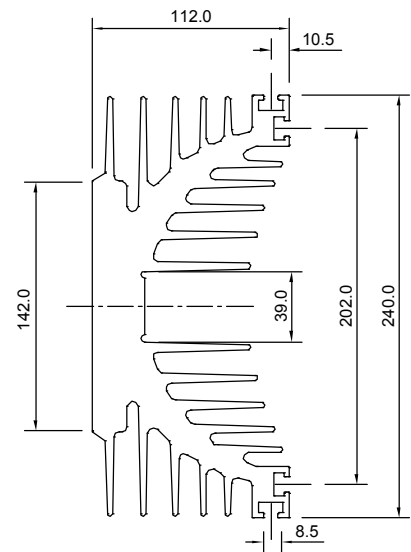

NOTE: DATA GIVEN IS FOR DOUBLE SIDE COOLING (i.e. 2 HEATSINKS)
 FOR SINGLE SIDE COOLING FACTOR x 2

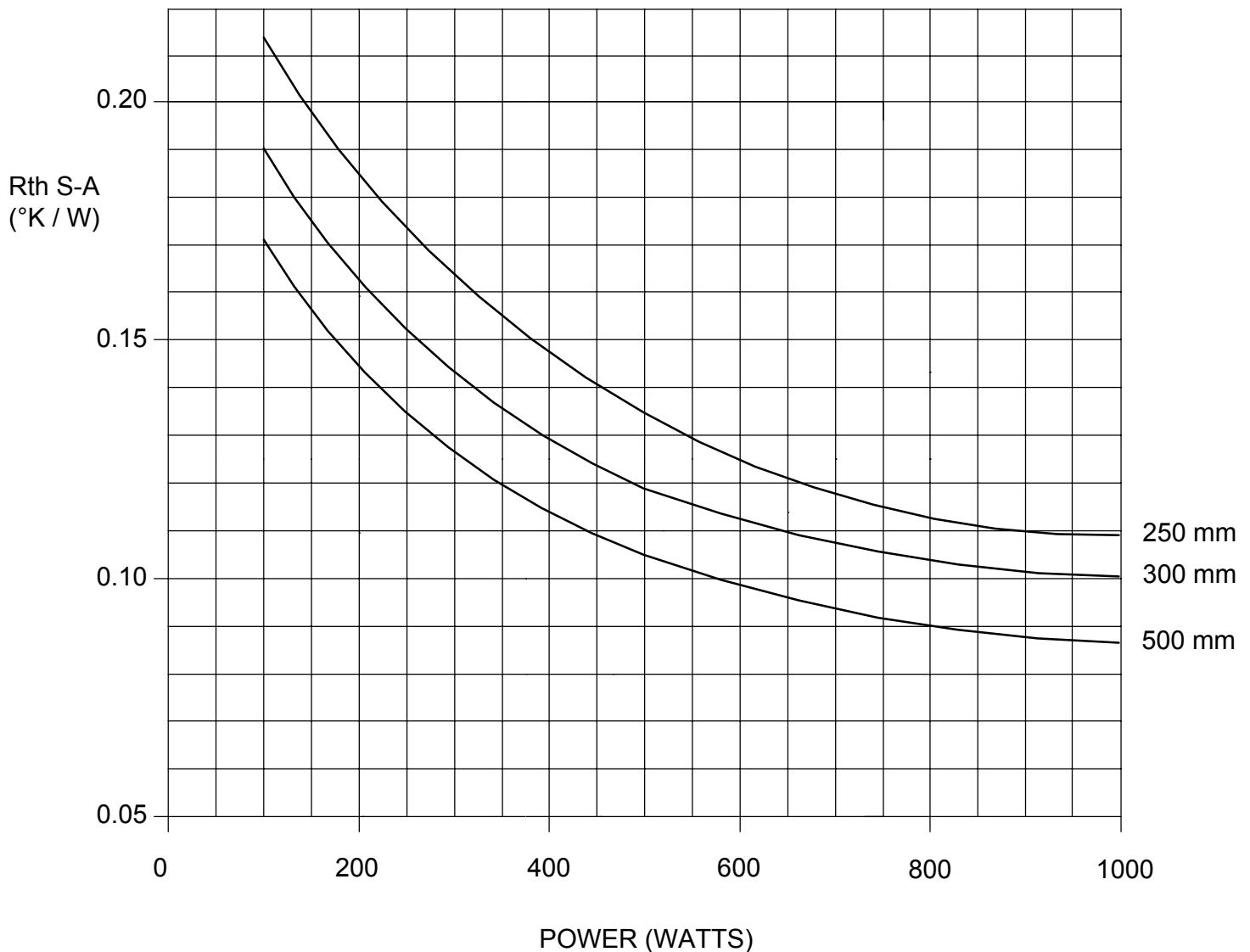

THERMAL RESISTANCE DATA. (SINK TO AMBIENT)

CONDITIONS: AIR NATURAL
 MATERIAL: PBX EXTRUSION TO DWG. 39-1512
 (LENGTHS AS INDICATED)
 WEIGHT: 29.0 Kg/m
 C.S.A: 11007 mm²

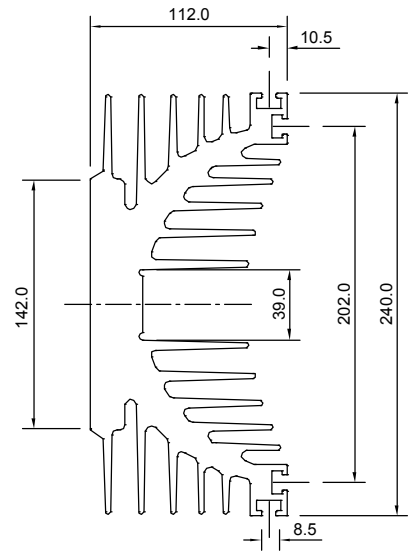

NOTE: DATA GIVEN IS FOR DOUBLE SIDE COOLING (i.e. 2 HEATSINKS)
 FOR SINGLE SIDE COOLING FACTOR x 2

